

(If no device is detected during tracing, please check whether the product is turned on and the Bluetooth of the mobile phone is turned on.)



(Figure 1)



(Figure 2)

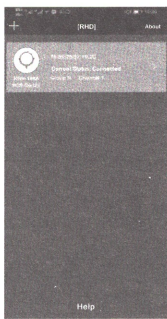

(Figure 3)

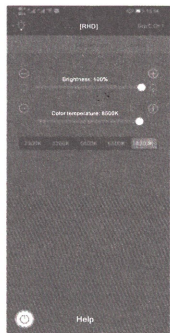

(Figure 4)

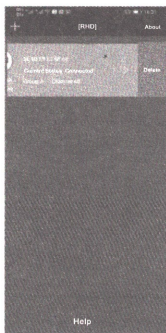

(Figure 5)

6. Product size

Unit: mm Tolerance: ±1.0mm L=539.2 W=22.8 H=548.3

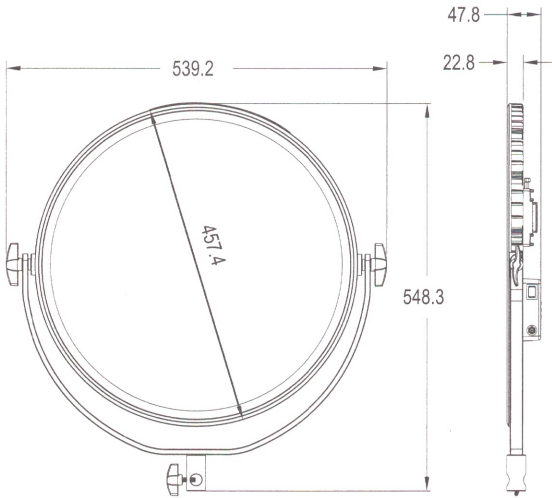

7. Product parameters

| Serial number | Item | Specifications |
|---------------|-----------------------------------|--|
| 1 | Product features | TFT color screen display, interactive operation interface. 49 kinds of scene presets, 360-degree color gamut full-color RGB. High color rendering index white LED. APP remote control. |
| 2 | LED qty | 5050 RGB 0.5W lamp beads 160 pcs |
| 3 | Max Power | 70W(±2W) |
| 4 | lighting parameter | Illumination: 1500 Lux/1m ±150 Lux Luminous flux: 2500 Lm ±200Lm CRI: CRI>95 ,TLCI>95 Color temperature range: 2500K-8500K ±200K Color gamut: 0-360 Saturation: 0-100 |
| 5 | Brightness scope | 1%–100% |
| 6 | Soft filter | 1pcs |
| 7 | Control mode | Button + knob + (2.4G remote control and Bluetooth APP optional) |
| 8 | Display screen | TFT color screen 1.77 inch |
| 9 | APP | Channel: CH: ALL-40 Group: GR: ALL-C Remote control distance: 15m |
| 10 | Illumination angle | >120° |
| 11 | Power supply | V–Mount Battery (need to buy separately) DC adapter 15V 5A |
| 12 | Connector | DC socket 5.5mm*2.5mm (positive inside and negative outside) |
| 13 | Product weight | About 3650g (photography light) |
| 14 | Humidity | 20% ~ 80% |
| 15 | Operating environment temperature | 0–35℃ |
| 16 | Storage temperature | –10 ~ 50℃ |
| 17 | Product size | 539.2 x 22.9 x 548.3 mm (photography light) |

8. Cautions

1. This light is not have dustproof and waterproof functions.
2. Do not let the light fall to the ground, be hit by collision or strong impact.
3. Do not cover the ventilation hole, otherwise the internal temperature may rise and cause fire or accident, which may cause the accident.
4. Do not look directly at the white LED, otherwise it may cause visual impairment.
5. Do not place the lights near flammable or easy-to-play solutions, which may cause fire or smoke.
6. The switch must be turned to "OFF" when finish the working.
7. If don't use led light or finish the working, please take out the NP-F batteries.
8. Please do not put the light into the storage box immediately after use; the heat may cause damage to the white LED. It should be cooled thoroughly before being placed in the storage box.

● Specifications and appearance are subject to change without notice.